

WARING COMMERCIAL

Europe Xtreme Blenders with Electronic Membrane
Keypad and a 30 Second Electronic Countdown Timer
with a 64 oz. Stainless Steel Container

MX1100XTEES MX1100XTSEES

Sound Enclosure

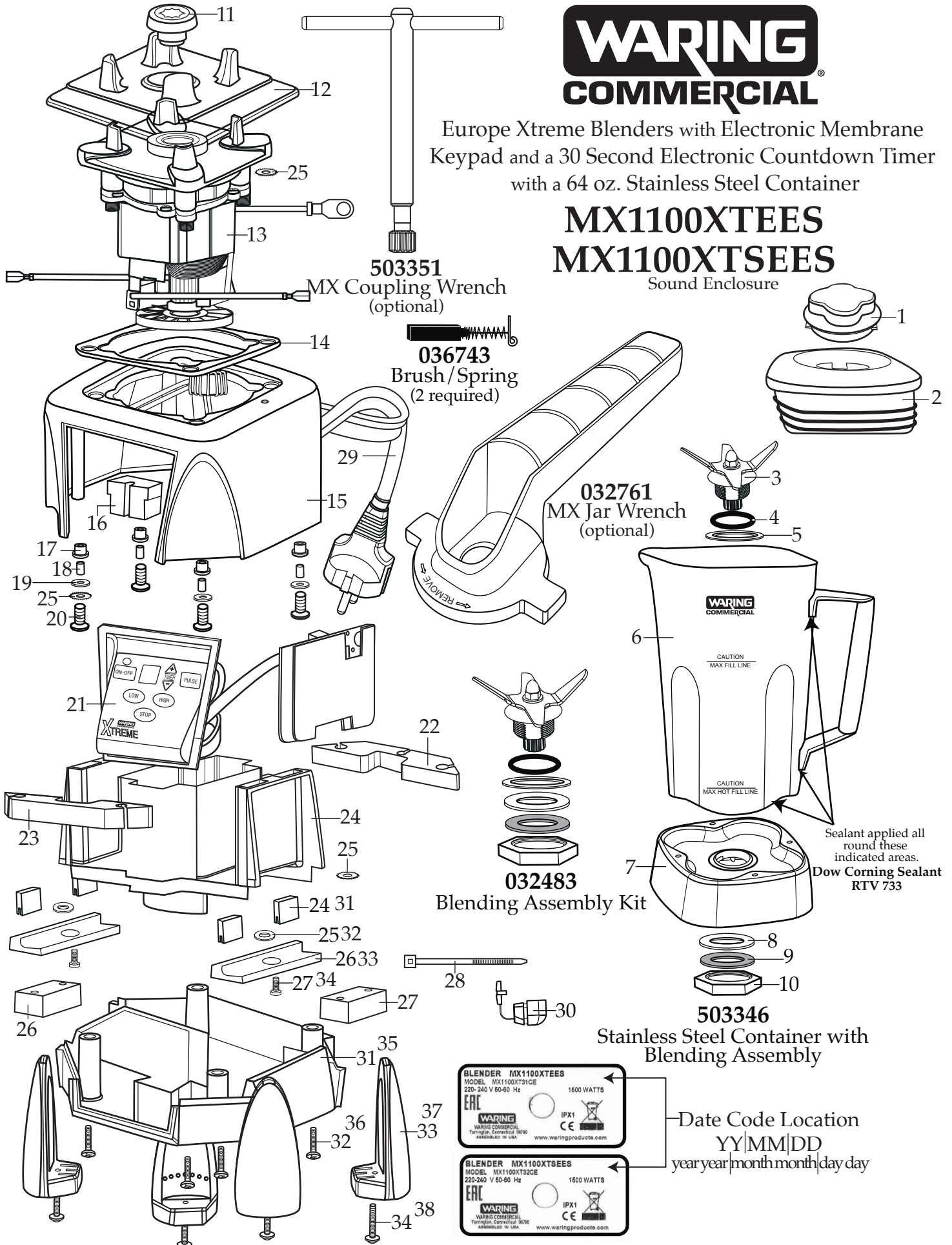

Catalog	Model
MX1100XTEES	MX1100XT31CE
MX1100XTSEES	MX1100XT32CE



Illustration#	Part#	Description
1	028769-E	Jar Lid Cover
2	028768	Jar Lid
3	503345	Blade Assembly
4	024271	O Ring
5	026798	Support Washer
6	026648	64 oz. Stainless Steel Container
7	026649	Container Support
8	026797	Bearing Holder Gasket
9	026796	Bearing Holder Washer
10	026795	Stainless Steel Jar Bearing Holder Nut
11	503601	Sq. Drive Coupling with Adapter <i>(changed after 3/29/2022)</i>
	503604	Sq. Drive Coupling with Adapter 2 Gen. <i>(changed after 6/1/2021)</i>
	028538	Drive Coupling
12	026442	Jar Pad
13	035398	Leili Motor without Sensor
14	038278	Dampening Plate Gasket <i>(on units after 8/25/2022)</i>
	026437	Dampening Plate Gasket
15	503382-E-67	MX Housings, Ferrite Core & Cord
16	028541	Motor Foam (2 required)
17	026439	Dampening Plate Bushing (4 required)
18	038486	Dampening Plate Sleeve (4 required <i>on units after 8/25/2022</i>)
	026453	Dampening Plate Sleeve (4 required)
19	026459	Washer (2 required)
20	028929	Sems (4 required)
21	036399	Control Panel with Interlock comes with key board-main board-filter board
22	028248	Top Housing Foam Rear Baffle
23	028249	Top Housing Foam Front Baffle
24		<i>Motor Housing is Included with Illustration# 15</i>
25	002943	Washer (3 required)
26	028247	Bottom Housing Foam Baffle
27	028542	Foam Baffle
28	013731	Cable Tie (3 required)
29		<i>Cord is Included with Illustration# 15</i>
30	007556	Strain Relief
31	034900	PCB Cushion (4 required <i>on units after 7/18/2019</i>)

Catalog
 MX1100XTEES
 MX1100XTSEES

Model
 MX1100XT31CE
 MX1100XT32CE

Waring Factory Service Center
 314 Ella T. Grasso Ave.
 Torrington, CT 06790
 Tele. 1-800-269-6640
 Fax 860-496-9017
 www.waringcommercialproducts.com

Illustration#	Part#	Description
32	037232	Flat Neoprene Washer (2 required <i>on units after 7/18/2019</i>)
33	037007	PCB Mounting Bracket (2 required <i>on units after 7/18/2019</i>)
34	013768	Screw (2 required <i>on units after 7/18/2019</i>)
35	<i>Bottom Housing is Included with Illustration# 15</i>	
36	012505	Screw (4 required)
37	026430	Corner Post (4 required)
38	028928	Sems (4 required)

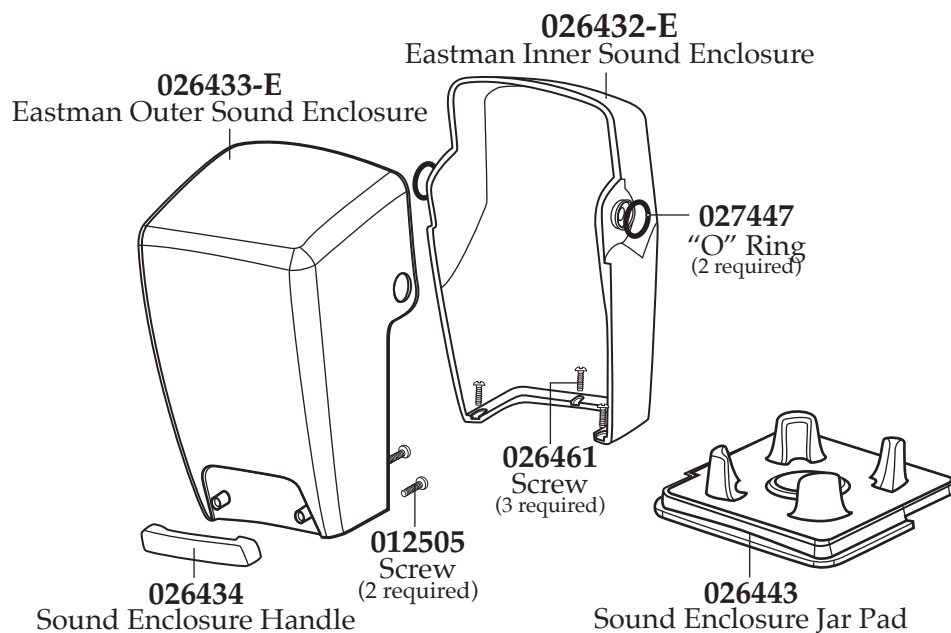

502962
SE1000

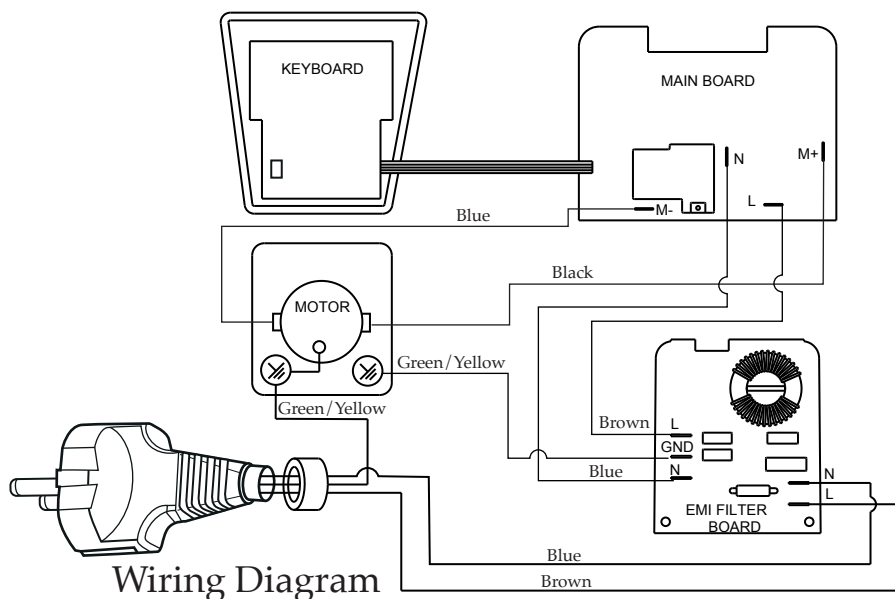

Wiring Diagram



037041
 Adapter
503601
 Sq. Drive Coupling
 with Adapter

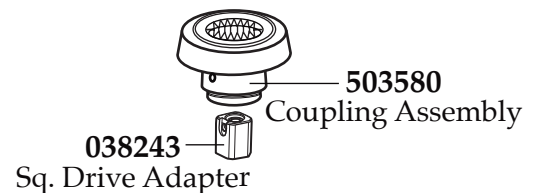

038243
 Sq. Drive Adapter
503604
 Sq. Drive Coupling
 with Adapter 2 Gen.